

Brass Finish LED Shower Set LED Shower Faucet and LED Handshower



INSTALLATION INSTRUCTIONS

INSTALLATION INSTRUCTIONS

Before you begin, read the installation instructions below. Observe all local building and safety codes.

Unpack and inspect for any shipping damages. If you find any damages, do not install. Contact Customer Service.

If you need assistance while installing your shower system, call our Customer Service number.

We recommend consulting a professional if you are unfamiliar with installing bathroom fixtures and plumbing.

TOOLS AND MATERIALS:

- Screwdriver
- Teflon Tape
- Adjustable Wrench
- Smooth Joint Pliers
- Soft Cloth
- Silicone Sealant



Installation Instructions

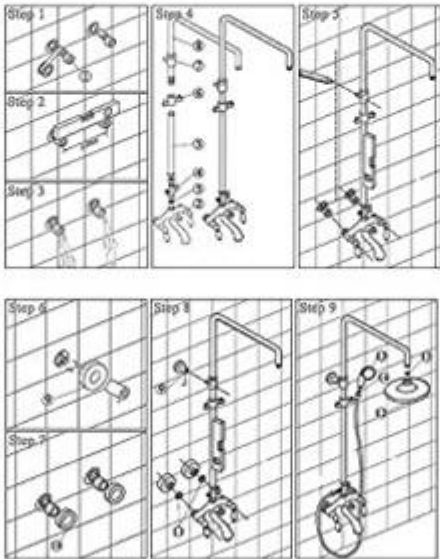

- | | | | |
|-----------------|----------------------|--------------------|-------------------|
| ① Brass Adapter | ⑤ Shower bar | ⑨ Mounting base | ⑬ Handheld shower |
| ② Faucet body | ⑥ Hand shower holder | ⑩ Decoration cover | ⑭ Washers |
| ③ Washers | ⑦ Shower bar bracket | ⑪ Washers | ⑮ Washers |
| ④ Diverter | ⑧ Shower bar | ⑫ Rain shower head | |

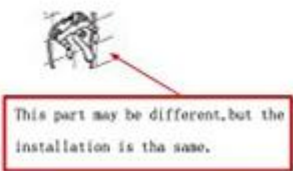

This General diagram and installation instructions are not intended for any specific model, but is presented as a general guideline for Installations!